



ANCOR

QUICK GUIDE



TABLE OF CONTENTS

1. Contents
2. Functions & Operation
3. Mounting on the Headrest
4. Mounting the Radio Module
5. Connecting an Existing Radio
6. Mounting the ANC Module
7. Commissioning & Service
8. Service & Contact
9. Other Useful Tools

1. SCOPE OF DELIVERY

BASE MODULE

ANCOR with
goosenecks

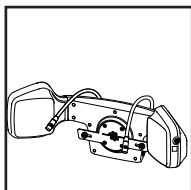

1x

ANCOR main
wiring harness

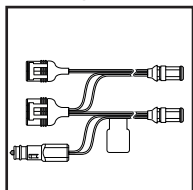

1x

Fixing material

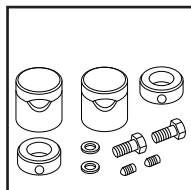

2 each

Operating manual
& quick guide

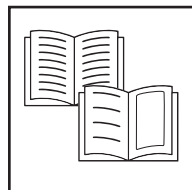

1 each

RADIO MODULE

Radio module

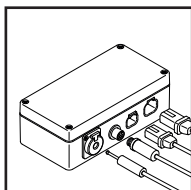

1x

Radio cable

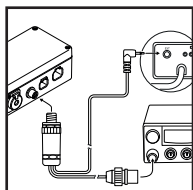

1x

AUX audio cable

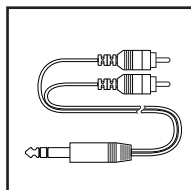

1x

PTT foot pedal

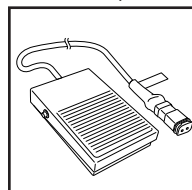

1x

ANC MODULE

Sensors

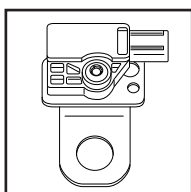

2x

Unterlegscheiben

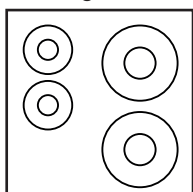

4x

Sensor cable

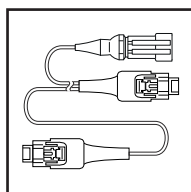

1x

EXTRAS

Cable protection
conduit

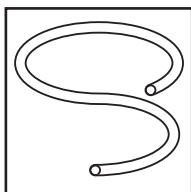

Cable tie

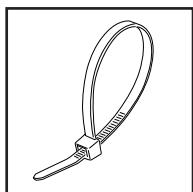

Mounting
plate

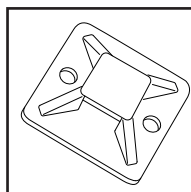

Also required:

Single-sided adhesive
tape
10 mm wrench
Scissors/cutter knife

2. FUNCTIONS & OPERATION



RESTARTING ANCOR

Press and hold the on/off button for 10 seconds until you hear a beep. The button will now turn red and ANCOR will restart automatically.



ESTABLISH A BLUETOOTH CONNECTION

Press and hold the on/off button for approximately 3 seconds until you hear a beep. When ANCOR is ready to connect, the button flashes blue. Now select "ANCOR" from the Bluetooth devices on your cell phone to establish the connection.



PLAY YOUR FAVORITE MUSIC

Use ANCOR as a soundbox and play your favorite music or radio stations via Bluetooth.



USE ANCOR AS A HANDS-FREE CAR KIT

As soon as your cell phone is connected to ANCOR, you can use it to make calls. Accept the call as usual on your cell phone and speak hands-free through the ANCOR speakers.

Note: When using an iPhone, you have to set a checkmark for Bluetooth headsets in the settings under Accessibility/Tapping/Call audio output.



HANDS-FREE RADIO (ONLY WITH RADIO ADD-ON MODULE)

Connect your radio to the radio module and receive radio calls automatically via ANCOR. To speak, press and hold the foot pedal.

Note: phone calls are automatically disconnected when the radio is switched on.



SWITCH ON ANC (ONLY WITH ANC ADD-ON MODULE)

Press the on/off button briefly to turn the ANC on or off. When it is on, the button lights up blue.

Caution: For proper ANC performance, make sure the goosenecks are centered on each side, close to the ears (as shown in the picture on the right).

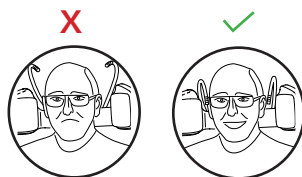

3. MOUNTING ON THE HEADREST

DANGER!

When the driver's seat is adjusted, parts of the vehicle controls may be triggered. People may suffer serious injuries if the vehicle starts or moves uncontrollably.

Only work on the driver's seat when the vehicle is switched off.

CAUTION!

When working on the clampable parts of the headrest and the ANCOR Headrest bracket, fingers or parts of the skin can be pinched.

Be careful while working.

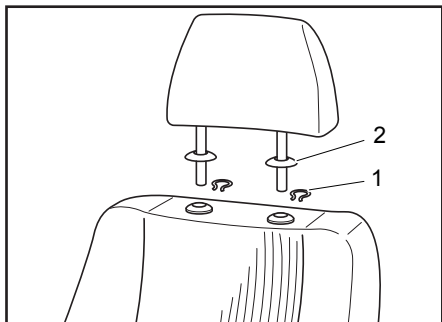

Pull out the headrest of the driver's seat as far as it will go.

Remove the covers (2) from the headrest guide.

Pull the retaining clips (1) out of the headrest guide recess.

Place the ANCOR Headrest outside the vehicle cabin on a flat surface.

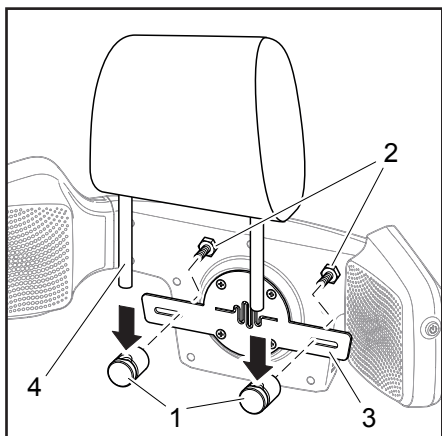

Guide the headrest rods through the clamping cylinders of the bracket on the ANCOR headrest.

Tighten the screws (2) on the back of the clamping cylinders (1) with a wrench (width 10 mm).

Put the headrest rods (4) back into the headrest guide.

Adjust the height of the headrest.

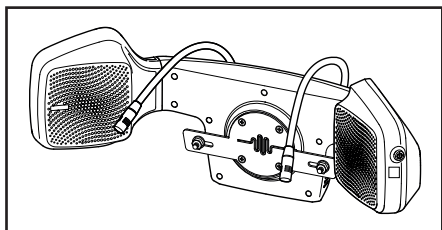

FOR ANC:

Adjust the height of the goosenecks so that the microphones are centered and close to the ears.

NOTE: If you have not ordered any additional modules (ANC), start with the commissioning on page 9.

4. MOUNTING THE RADIO MODULE

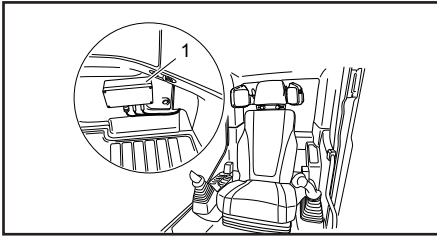

Mount the radio module (1) inside the vehicle, close to the ANCOR Headrest.

Clean the area if necessary.
Attach the radio module using the Velcro tape.

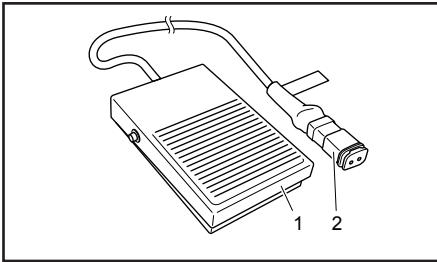

Attach the PTT foot pedal (1) in a suitable place in the footwell using the Velcro strap.

Clean the surface before you stick the foot pedal on.

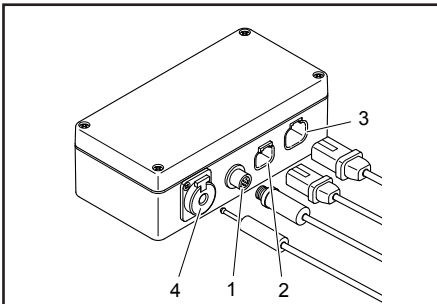

Connect the cables to the radio module as follows:

- 1 - Radio cable connection
- 2 - Push-to-talk connection
- 3 - Connection to main cable harness
- 4 - Radio connection

Fix and secure any loose cables.

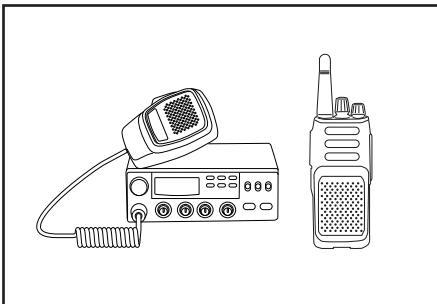

Depending on the radio you are using, it is connected to the radio module in a different way.

Both options are described below.

CONNECTION HANDHELD- OR CB MOBILE RADIO

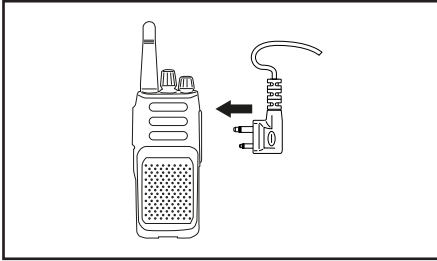

Remove the protective cap from your handheld radio.

Connect the radio cable to the radio and the radio module.

If you charge your radio while using it, the ANCOR and radio should be at the same voltage potential.

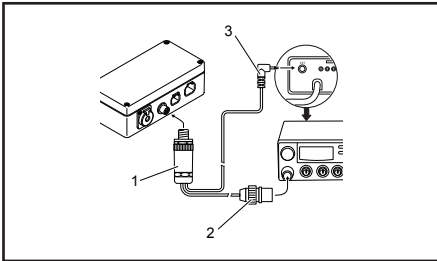

Connect the supplied radio cable to the universal connector of the mobile radio (3)

and the PTT connector on the front (2).

Now connect the radio cable to the radio module (1).

5. CONNECTING AN EXISTING RADIO

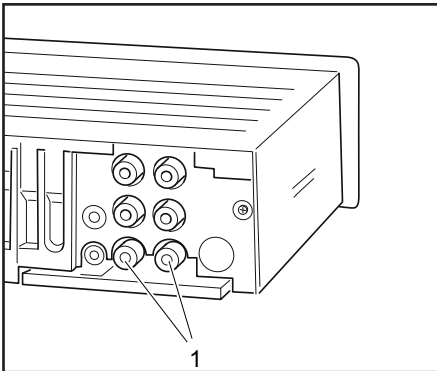

Remove the radio.

Connect the two cinch connectors of the supplied AUX cable to the sockets of the preamp outputs (1).

Deactivate the machine speakers. Insert the 6.3 jack plug of the AUX cable into the radio module.

6. MOUNTING THE ANC MODULE

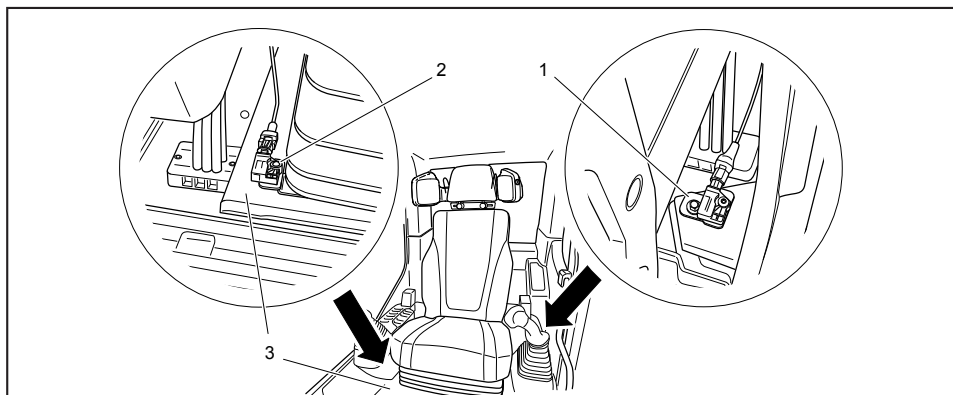

Mount at least two ANC sensors (2) on the machine.

The ANC sensors can be mounted anywhere on the vehicle using the existing screw points.

Recommended positions for the sensors:

Front right of the seat (3).

Left of the seat at the bottom of the door (1).

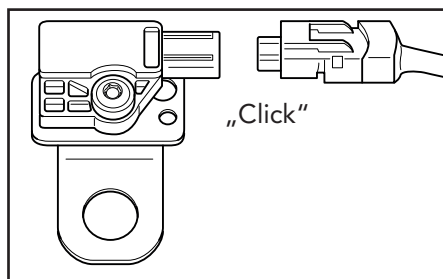

Connect the sensors to the ANC cable using the connectors.

The red lock must be pushed forward after the click has been heard.

Secure all loose cables with cable ties and, if needed, use cable protection tubing. Make sure that they do not pose a tripping hazard.

ACTIVATING ACTIVE NOISE CANCELLATION

If you have selected the ANC module, ANCOR must be calibrated by one of our experienced service technicians before using active noise cancellation. To make an appointment, use the contact options listed below.

All other ANCOR functions (see p. 4) can be used immediately after connecting to the power supply.

7. COMMISSIONING & SERVICE

ESTABLISHING THE POWER SUPPLY

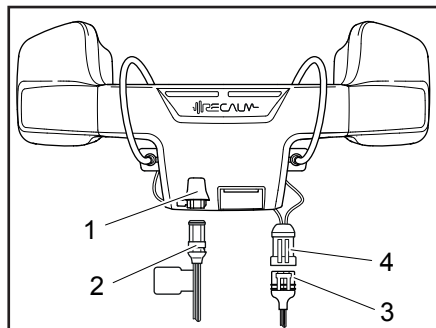

Fold the backrest of the driver's seat to a horizontal position.

Insert the plug (2) into the connector on the underside of the ANCOR headrest (1).

Connect the Superseal connector (3) to the plug of the gooseneck microphone (4).

Fold the backrest back.

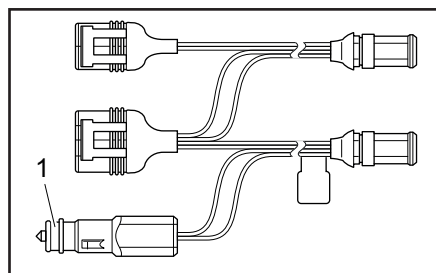

Insert the vehicle plug (1) into the vehicle's on-board power supply socket.

Turn on the vehicle ignition to establish the power supply.

The ANCOR Headrest will initiate the start-up process.

The red LED on the ANCOR headrest button will light up constantly.

As soon as the start-up process has been successfully completed (after approx. 60 seconds), the red LED will go out and the "System ready" signal tone will sound.

NOTE: If ANCOR does not start up as expected or continues to glow red, please refer to our user manual for more tips and hints on beeps.

8. SERVICE & CONTACT

To make an appointment, with queries or other concerns, contact the authorized dealer or the recalm service. We will get back to you as soon as possible.



WhatsApp service
+4915258493243



Service requests
service.recalm.com

For more information, visit us at www.recalm.com or follow us on social media!

9. OTHER USEFUL TOOLS

RECALM APP

Download the “recalm app” from the Play Store (currently only available for Android).

With the app, you can conveniently control ANCOR via your cell phone and, for example, turn active noise reduction on and off or display the sound pressure level at the gooseneck microphones (only possible with the ANC module).

Stay tuned, because more features will follow.

MORE INFORMATION THANKS TO QIKY

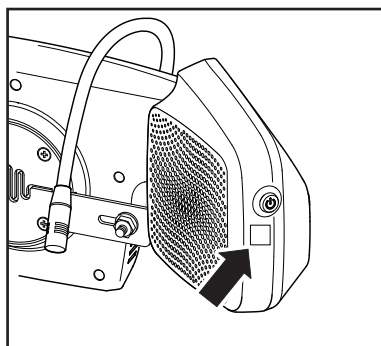

On the side of your ANCOR, you will find a QIKY QR code that gives you quick access to your ANCOR serial number, operating instructions and additional information. It also makes it easy for you to contact customer service.

Simply hold your cell phone camera over the QR code until a web link appears. Click on it to access all the information.